

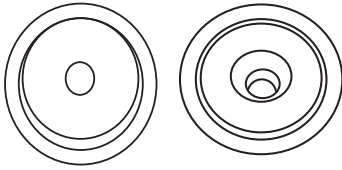

INSTALLATION INSTRUCTIONS

FOR CONCEALED MAGNET CATCH FOR DUMMY DOORS

PARTS



2 magnetic Housing Cups

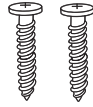

2 screws

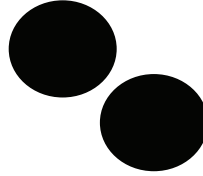

2 cover magnets

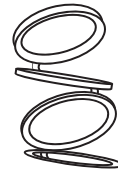

2 adjustment rings

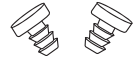

2 rubber buffers

STEP 1

Drill a hole the depth of the housing cup into the top of your **door** and **doorframe** using a spade drill bit. (not included)

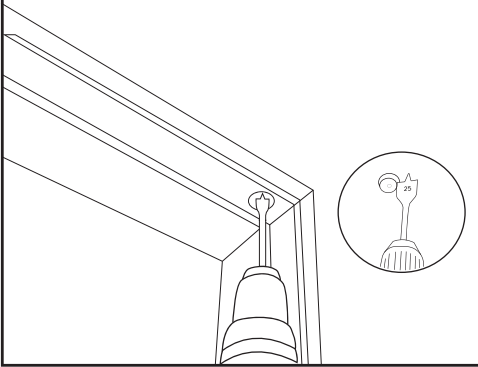

STEP 2

Drill a magnetic housing cup into the top of the door. (If the gap between your door and doorframe is too large, put an adjustment ring around the magnetic housing cup before installing to lift the magnet and increase its strength.)

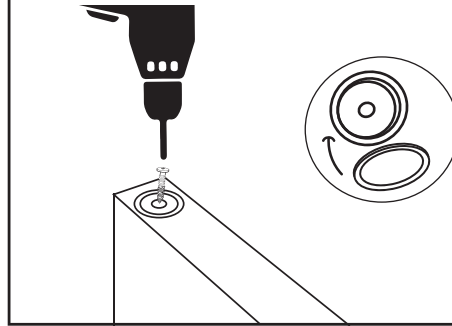

STEP 3

Drill the second magnetic housing cup into the doorframe.

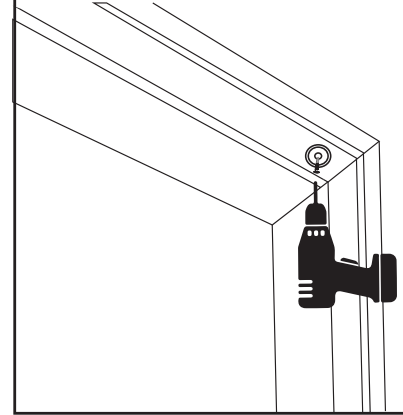

STEP 4

Cover both magnetic housing cups with the magnet covers.

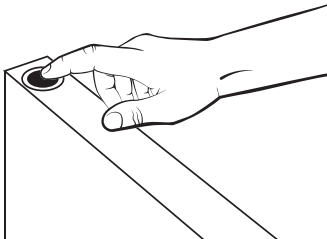

STEP 5

Test the magnet catch door to make sure it operates smoothly.

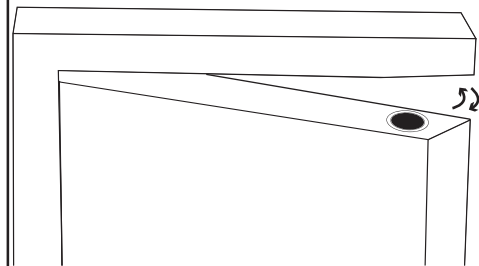

STEP 6

OPTIONAL: Screw the rubber buffers into the doorframe at a 90 degree angle for a softer, quieter close.

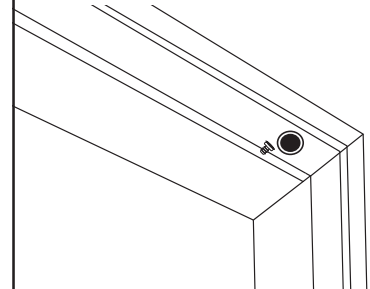

Concealed Magnet Catch For Dummy Doors

Questions? We are here to help!
Please email support@megahandles.com